

**Get the Connection!**

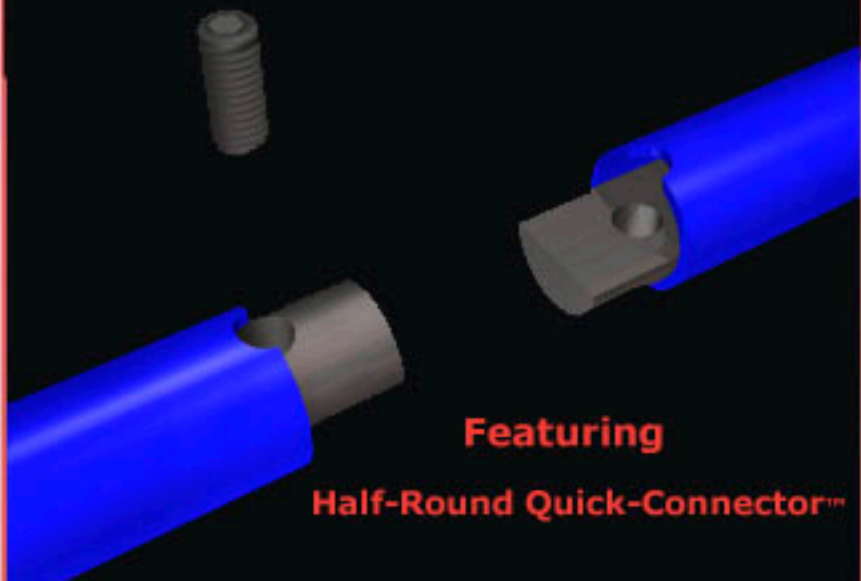

**Featuring  
Half-Round Quick-Connector™**

# Truss Sizes

## Flat Truss

## Triangular Truss

## Square Truss

### 3

**Construction** - 3/8" tube cords with 1/8" wire webbing.

**Connection** - Single 1/2" Bolt & Nut.

**Typical Uses** - Furniture, lighting portable exhibits, other decorative uses. Used generally in small displays with spans of no more than 10' and only minimal weight loads.

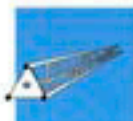

### 10

**Construction** - 3/4" tube cords with 3/16" wire webbing.

**Connection** - Half-Round Quick Connector™.

**Typical Uses** - General purpose, lighting, monitor, and support, exhibit structure, other decorative uses. Used heavily as standard in stores, nightclubs, and small to medium single story exhibits with spans of 30' or less and weight loads up to 300 lbs. depending on configuration.



### 14

**Construction** - 1" tube cords with 1/4" wire webbing.

**Connection** - Half-Round Quick Connector™.

**Typical Uses** - General purpose, lighting, monitor, and signage support, exhibit structure, other decorative uses. Used for a beefier look in stores, nightclubs, and larger exhibits with spans of 50' or less and weight loads up to 600 lbs. depending on configuration.



### 18

**Construction** - 1 5/8" tube cords with 1/2" tube webbing.





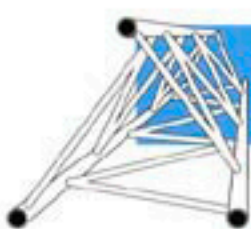



**Connection** - Half-Round Quick Connector™.

**Typical Uses** - Structural purpose, lighting, monitor, and signage support, exhibit structure, other structural uses. Used as a structure for larger or two story exhibits with spans of 100' or less and weight loads up to 4,000 lbs depending on configuration.

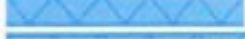

# Truss Parts

## Straight Lengths

A1	1' Length	
A2	2' Length	
A3	3' Length	
A4	4' Length	
A5	5' Length	
A6	6' Length	
A7	7' Length	
A8	8' Length	

Lengths are available in 1/8" increments starting at 2" with a maximum of 8". For pricing purposes, round up 1 size.

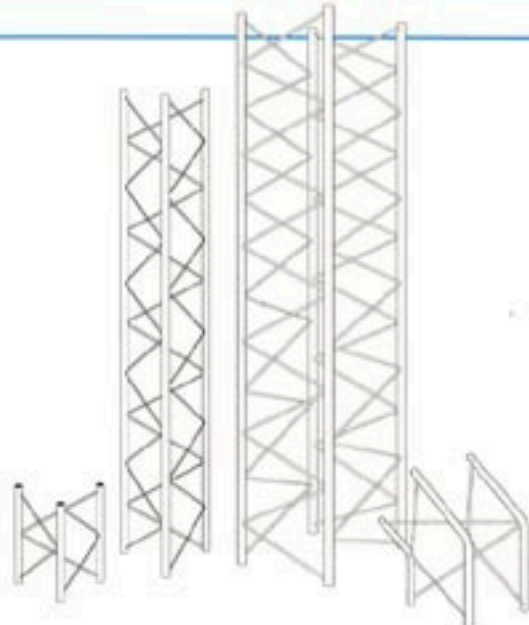

## Truss Parts

	VERTEXES		
	UPPER	INSIDE	OUTSIDE
CURVE	B1	B2	B3
TURN	C1	C2	C3
TEE	D1	D2	D3
X	E		
45 TURN	F1	F2	F3
2' RADIUS	R11	R12	R13
4' RADIUS	R21	R22	R23
9' RADIUS	R31	R32	R33

### B - type turns

Octagonal shaped 90° turns



Available in 10" and 14" truss only.

### F-type turns

45° turns



Available in all 3", 10", 14", 20" and custom truss systems.

## Dimensions

	A	B
T3, S3	10"	8"
T10, S10	16"	7.5"
T14, S14	24"	10"
T20, S20	30"	16"

### C - type turns

Right angle turns



Available in all 3", 10", 14", 20" and custom truss systems.

### R1 - 2' Radius

2' Radius 90° Curve



Available in truss systems over 5" in size. e.g. 10", 14", and custom.

### D - T-trusses

T-connectors

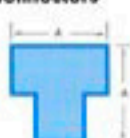

Available in all 3", 10", 14", 20" and custom truss systems.

### R2 - 4' Radius

4' Radius 45° Curve



Available in truss systems over 5" in size. e.g. 10", 14", and custom.

### E - X-trusses

X-connectors



Available in all 3", 10", 14", 20" and custom truss systems.

### R3 - 9' Radius

9' Radius 30° Curve



Available in truss systems over 5" in size. e.g. 10", 14", and custom.

### G - Baseplate



### H - End Frame



### I - Extended End



### J - Track Clip (set of 4)



### K - Shackles (set of 4)



## How to design with Truss

### 1. Pick a truss system

**Size** - Decide aesthetically and structurally what size truss you need. For example: 10' truss is great for a department store with 10' or lower ceilings but in a more open environment, you may want to use a 14' truss even though it is not necessary for structure.

**Shape** - Another option is the shape of the truss. A flat truss can achieve almost as beefy a look as a triangular truss at a great savings where strength is not an issue. However, a long span with considerable load may necessitate moving from triangular to square when going to a larger size is aesthetically not appropriate.

### 2. Lay it out

**Junctions** - As you lay out your truss system, keep in mind the size of the junction pieces. Turns, tees, and "X" trusses have a set dimension. For instance, in the 10' truss, a junction piece takes up 1'4" in each direction so if you have a turn at each end of a 20' run, you need 17'4" of straight truss.

**Vertex** - When using triangular truss, vertex has to be considered. The vertex is the point of the triangle. The most popular configuration aesthetically is vertex down on the horizontal sections of the truss. In nightclubs, it is often installed vertex up to accommodate more points to affix lighting to. A great way to frame a kiosk is to use the truss vertex in and mount signage to the flat side of the truss facing out.

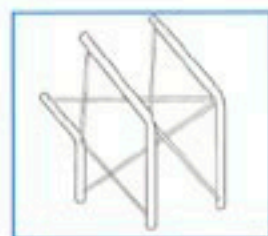

F2 45° Turn



B2 Turn Inside Vertex



S10-C Square Right Angle Turn

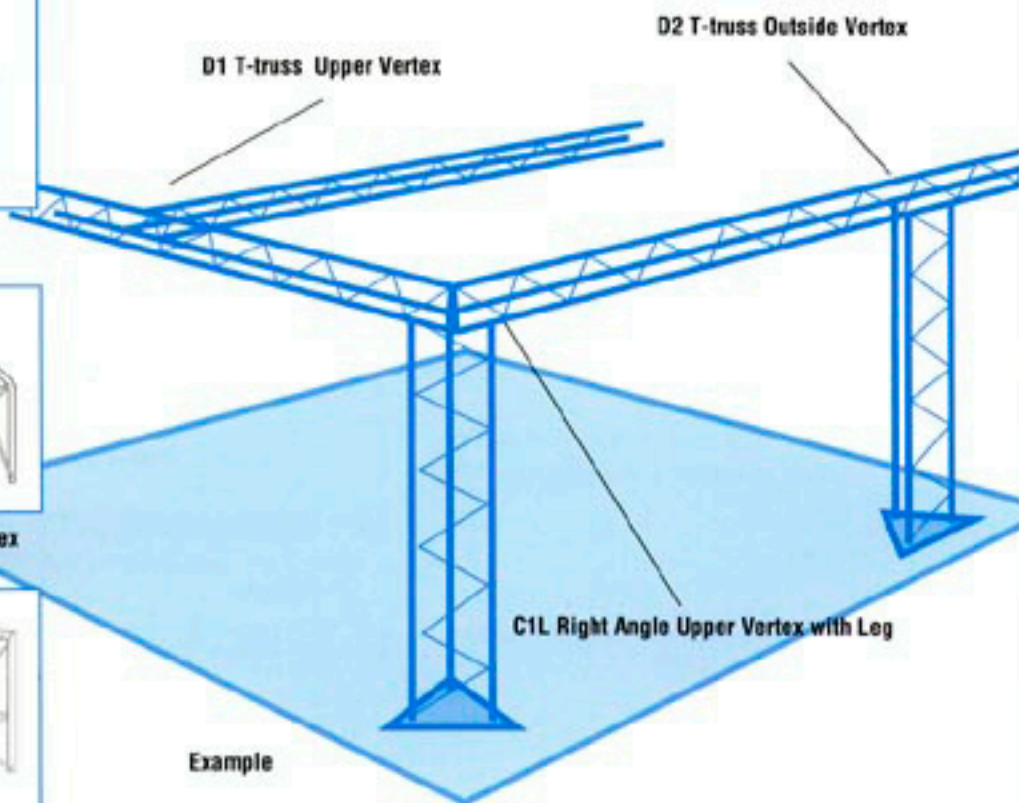

# Merchandising Truss



A functional truss designed for the retailer. This truss is specifically designed for the small store or for a department within a large store. Utilizing two opposing laddered sides for supporting shelving, hanging rods, gridwall, and most grid-wall accessories, the ten inch sides keep the strength and look of truss with the standard T10 diagonal webbing.

## 4-10 Merchandising



4"X10" rectangular truss, 3/4" steel tube cords with 3/16" steel rod webbing on 10" sides and 1/4" steel ladders, 3" O.C. on 4" sides. All turns, T-Trusses, X-Trusses, and capitals have a 1 1/4" O.D.

**B1 - Turn, inner ladder**

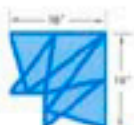

**B2 - Turn, upper ladder**



**C1 - T-truss, inner ladder**

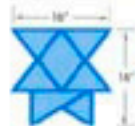

**C2 - T-truss, upper ladder**



**D1 - X-truss, inner ladder**



**D2 - X-truss, upper ladder**

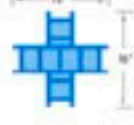

**E - Base Plate**



Standard base plate used in most merchandising configurations.

**E1 - Rack Base Plate (Large)**



Extra large base plate used when 410 truss is used as a freestanding fixture.

**F - End Frame**



Standard end frame used to cap off dead ends cleanly.

**F1 - Rack End Frame**



End frame used in conjunction with rack base plate to convert 410 truss into a clothing rack.

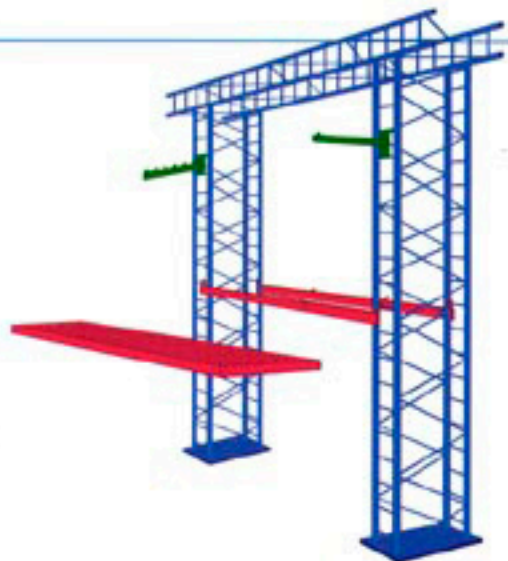

**G - Combination Shelf Support** G1 - 3'0";

G2 - 4'0"; G3 - 5'0" (set of 2)

Used in pairs with 410 truss, this sturdy shelf support firmly holds glass, wood, or steel shelving in place. This support is also used to hand gridwall on the 410 truss.

**H - Gridwall Holder** (set of 4)

Used in conjunction with shelf support to mount gridwall behind shelving on 410 truss

**I - Expanded Metal Shelving** I1 - 1'0"X3'0";

I2 - 1'0"X4'0"; I3 - 1'0"X5'0"

Used on shelf support, this great looking shelving is constructed of flattened 1/2" slot metal with 1/2" iron frame.

**J - Track clip**

Used to mount track and display lamps onto 410 truss.

**K - Grid Clip**

Used to mount merchandise directly to 410 truss or gridwall.

**L1 - Tubular Face-Out**

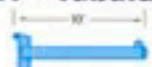

Can be used on 410 truss or any 3"X3" grid.

**L2 - Tubular Waterfall**



Can be used on 410 truss or any 3"X3" grid.

**M - Hanging Rod**

Used on 410 truss, 1/2"X1 1/2" rectangular tube to accommodate standard hanging rod accessories.